

# Setup Guide for Assembling a Square Shower Frame and Base

## Step 1:

**Introduction** This setup guide provides a step-by-step procedure for assembling a square shower frame and base, featuring a double sliding door shower model. The shower model is available in three different sizes and is specifically designed to fit snugly in a corner.



## Step 2:

**Square Shower Tray Assembly** Begin by assembling the square shower tray. Level the shower tray feet beneath the base and connect it to the waste pipe for proper drainage.

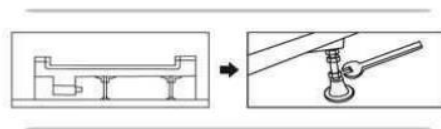
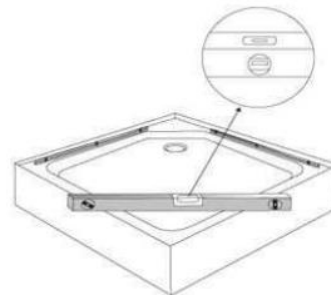

## Step 3:

**Rear Panel and Water Supply** Attach the necessary accessories to the rear panel and connect the water supply hoses to the water mains. It is essential to test for any potential leaks in the hoses located behind the rear panel.

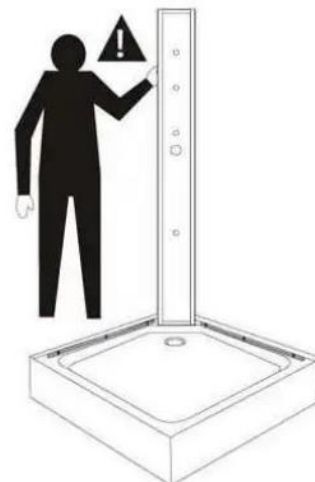

**Step 4:**

Locking the Side Rear Wall Next, secure the side rear wall to the middle panel. The bottom of the wall, made of aluminium, will slide under the base and lock into position. Additionally, attach any included accessories to the wall.

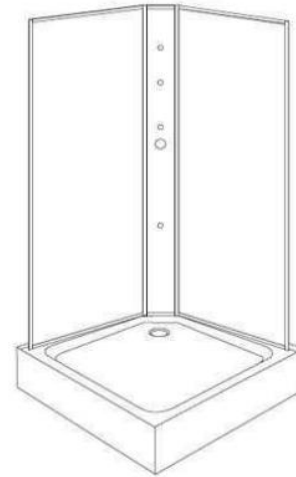

**Step 5:**

Repeating the Process Repeat the previous step for the second side rear wall to ensure proper alignment and stability.

**Step 6:**

Installing the Door Rails Place two door rails at the front of the shower tray, following the image provided for reference.

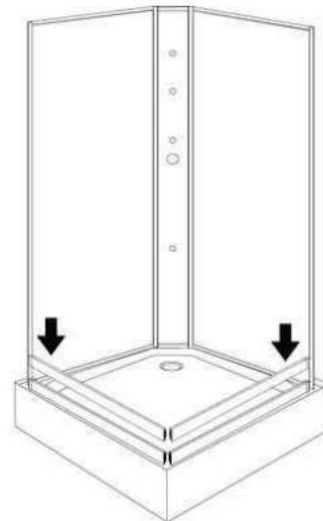

**Step 7:**

Locking the Front Fixed Glass Lock the front fixed glass to the rear side wall and rotate it into position. Slide the rear side wall downward so that the cut-out aligns with the block on the door rail.

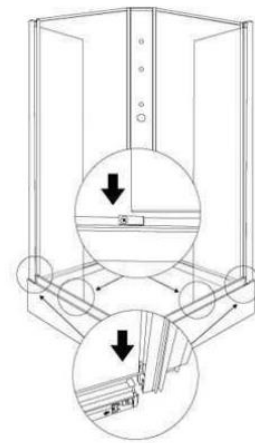

**Step 8:**

Sliding the Top Rails Slide the top rails, allowing the blocks to fit securely into the slots of the front fixed glass, made of aluminium.

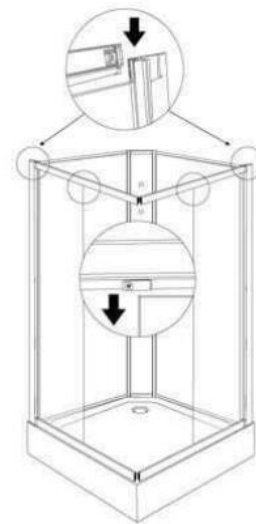

**Step 9:**

Connecting the Door Rail Connector Blocks Attach the door rail connector blocks at the midpoint where the door rails meet. This applies to both the top and bottom door rails.

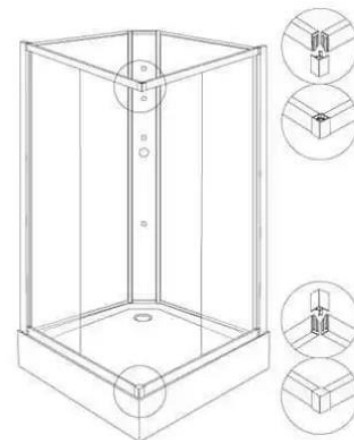

### Step 10:

**Locking the Rails** Slide the locking blocks onto each corner of the rails to ensure they are firmly locked into place.

### Step 11:

**Door Adjustment** The top wheels serve the purpose of adjusting the door's level. Attach the magnetic door strips and trim them to the appropriate length. Also, attach the door handle for added convenience. The bottom wheels come with a push-button for a quick-release mechanism.

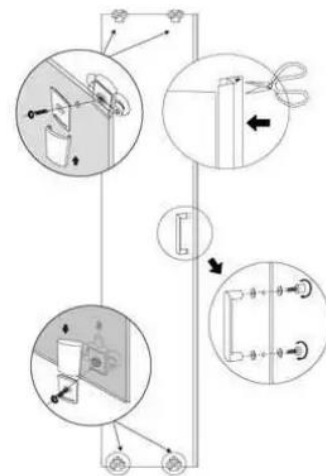

### Step 12:

#### Wheel Installation

Hang the top wheels onto the top curved rail.

Insert the bottom wheels into the bottom curved rail using the provided buttons.

If the bottom wheels fail to spring back up into the curved rail or if the door is not level, adjust the top wheel using the screw located below it.

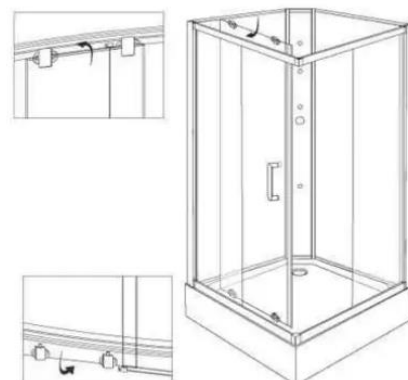

**Step 13:**

**Splash Strips** Finally, attach water splash strips to both the front fixed glass and the inner section of the door. Trim any excess splash strip material for a neat and tidy appearance.

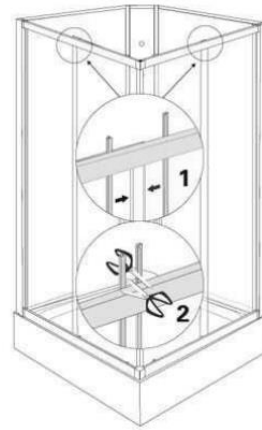

This comprehensive setup guide will help you successfully assemble your square shower frame and base, creating a comfortable and functional showering space. If you have any questions or need further assistance, feel free to ask.